

15/11/2019

DOC158510 002

Designation	Soliris io – Wind & Sun sensor
Reference(s)	1870531 Soliris 230V io RNF 5m - 1870532 Soliris 230V io W/O Cable
Range	io Sensor range

FUNCTIONS

1. 230 V AC wired sensor
2. Applications: Awnings, Screens, Zip-screens & EVBs...
3. Wind function
 - a. Threshold set locally on the sensor
 - b. Threshold from ~28 to ~88km/h
4. Sun function
 - a. Threshold set locally on the sensor
 - b. Threshold from 0 to ~50 Klux
5. Rain function (optional): connect Ondéis Rain sensor (wired)
 - a. Rain behaviour:
 - b. Security: go to UEL when raining
 - c. Comfort: go to DEL when raining



TECHNICAL SPECIFICATIONS

Box	Material Color Size Protection factor against solid & splash proof	ABS grey 235 x 160 x 60 mm IP 34
Power supply	Nominal limits Frequency	230 V~ Class II 207-253 V~ 50 - 60 Hz
Rain Sensor	Ondéis (ref 9016345)	1 sensor
Radio frequency		868.00MHz/868.70 MHz /869.70 MHz
Radiated power		Min +3 dBm
Radio Range	Use guaranteed in «Home installation» depending of the environment	
Modulation type		FSK dev. +/-19.2KHz
Protocol		io homecontrol
Antenna		Integrated
Temperature range	Storing Working	-30°C / +70°C -20°C / +50°C
Drop test		1 (height: 2m)
Wind measurement		28 to 88 km/h
Thresholds Number		6
km/h values		28/38/49/61/74/88 km/h
Beaufort values		5/ 6/ 7/ 8/ 9/ 10 Bft
Default threshold (and value)		1st (28 km/h / 5 Bft)
Wind max resistance		150 km/h
Sun measurement		
Thresholds Number		6
Lux values		1,8.3,16.7,25,33.3,41.7,50
Default threshold (and value)		25 Klux
Bird resistance		1500g
Weight		380g / 280g w/o cable
Standard (CE)		

Safety of the use: EN 60730-1

Health of the user: EN62479:

Electromagnetic compatibility : EN 301 489-3 EN 301 489-1; EN60730-1:

Radio Spectrum : EN 300 220-1- EN 300 220

DESCRIPTION

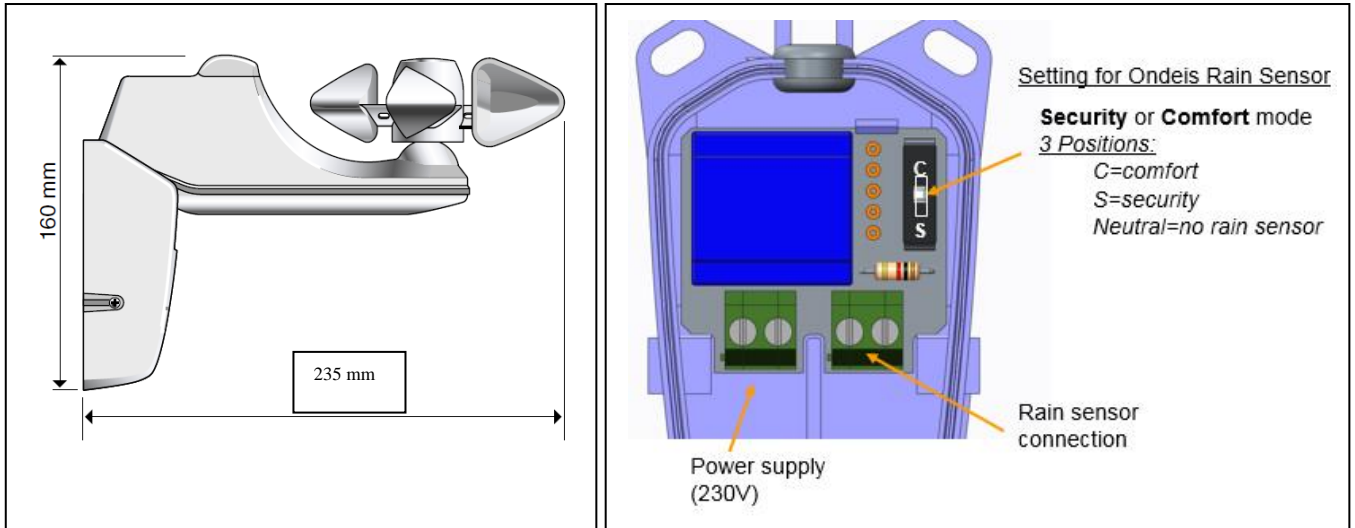

COMPATIBILITIES

See compatibility matrix

INSTALLATION

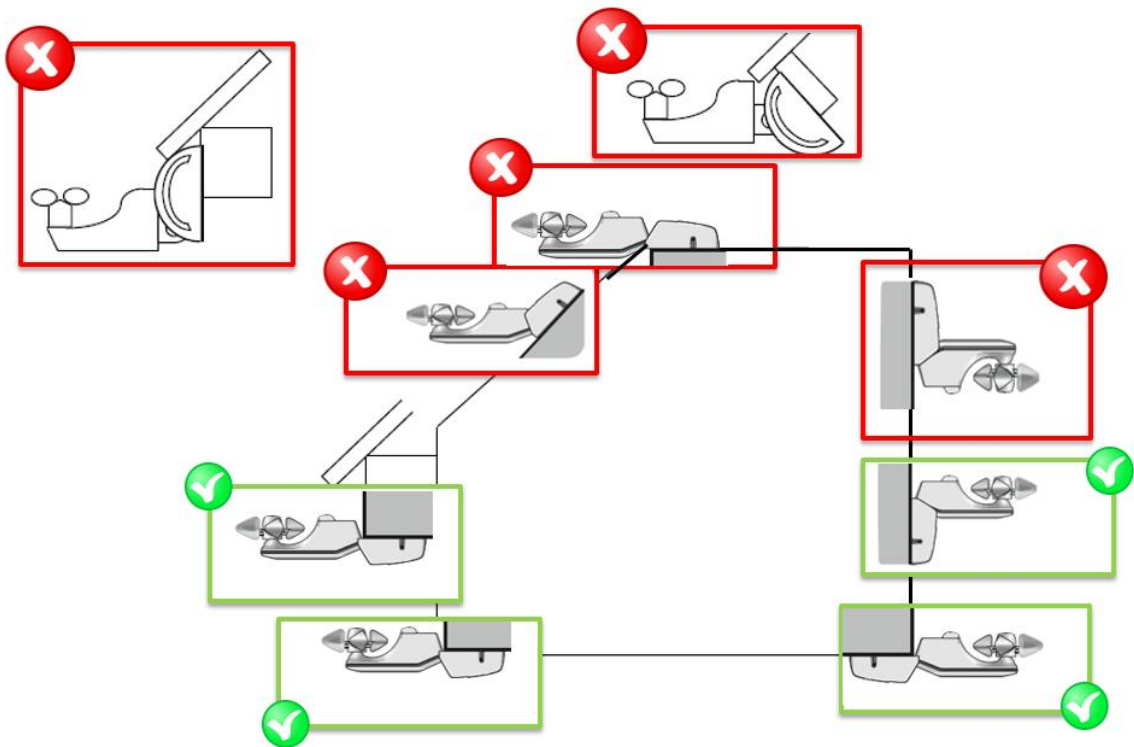

BE – R&D

QUALITY

MARKETING