



TECHNICAL DATA SHEET

21 - 07 - 2020

TDST DOC152784 000

Designation	Situo 5 io/RTS
References	1811728 Situo 5 io/RTS Pure FR CE 1811736 Situo 5 io/RTS Pure SE MEA 1870706 Situo 5 io/RTS Pure NE 1870707 Situo 5 io/RTS Pure EE
Range	1W io/RTS homecontrol remote control

FUNCTIONS

Situo 5 io/RTS

- Enables to drive five io and RTS applications or group of io and RTS applications remotely.
- Manage all io homecontrol and RTS actuators through a basic 0% - 100% control.
- Manage io homecontrol and RTS lights (ON-OFF)
- Manage io homecontrol and RTS heating (ON/OFF)



Situo 5 io/RTS

TECHNICAL SPECIFICATIONS

Box	Material	ABS, SEBS
	Material (Buttons) Color	Silicone Grey & White (Pure)
	Size	145x36x14mm
	Wall support size	38x14mm
Weight		55g (including battery)
Battery	Voltage	3V
	Type	CR2430
Product autonomy	(10 actions and 5 group selections per day)	5 years
Radio frequency		868.95MHz + 433.42 MHz
Radiated power		+5dBm (868MHz) and -4dBm (433MHz)
Radio Range		150m in free field
		Use guaranteed all over « floor / facade installation » depending of the environment.
Modulation type		FSK +/-19.2kHz (868MHz) and OOK (433MHz)
Protocol		io homecontrol 1W and RTS
Antenna		Integrated
Temperature range	Storing	-20°C / +60°C
	Working	0°C / +48°C
Standards	Electromagnetic compatibility	EN301489-3 EN301489-1
	Electrical safety	EN 62368-1
	Health protection	EN 62479
	Radio	EN 300220-1 EN 300220-2

DESCRIPTION

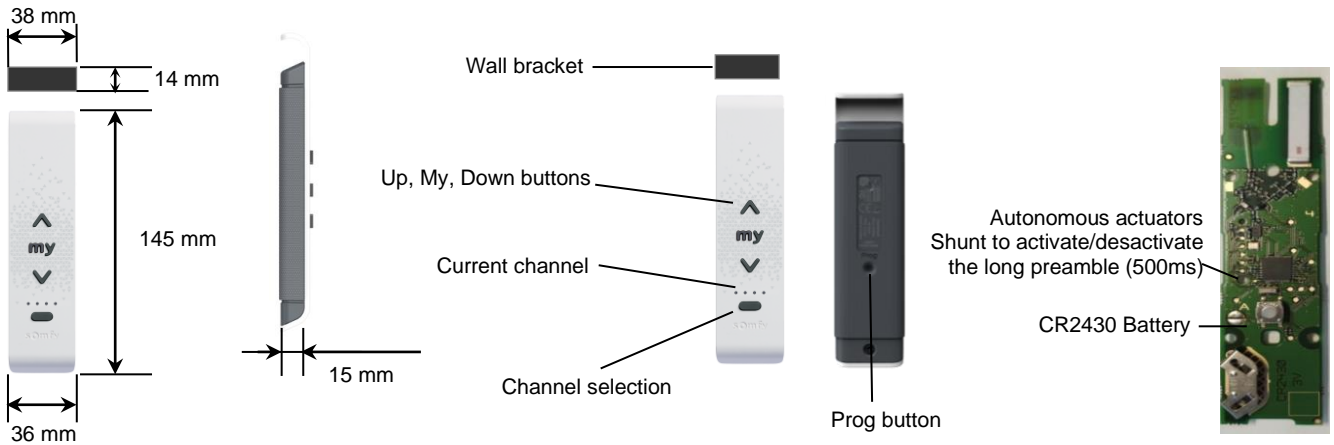

MACRO FUNCTION / RESTRICTION

Macro function :

- Up/ My /Down and Stop function
- Record / Modification & Reset of the My
- LPM Mode
- Possibility to wake-up actuators (Up+Down)

Restriction :

- No settings / re-settings
- No possibility to reset actuators
- No Tilting / Dimming function

INSTALLATION / USAGE

- Short press on the PROG button (0.5s) to pair your product to a "awake" actuator.
- Long press on the PROG button (2secs) to wake up the actuator already paired.
- Press on up button sends open / switch on to applications (Roller, Screens, Lights, IVBs, Curtain ...)
- Press on down button sends close / switch off to applications (Roller, Screens, Lights, IVBs, Curtain ...)
- Short press on "My" sends stop if actuator is moving. It sends "My" order if actuator is already stopped.
- Long press (5secs) on "My" saves "My" position inside the actuator. If the actuator is already in "My" position, it will erase the "My" position (depending on the actuators).
- Use channel button to choose the channel you want to control.

ADVANCED SETTING

«Low Power Mode»

The LPM is a mode on our controls that allow to send orders to the autonomous motos : Wirefree or Solar. Regarding the Situo 5 io / RTS, the LPM mode (preamble at 250ms included in the radio frame) will always be activated whatever the channel → Transparent ergonomic

Exception : The Velux autonomous motor need to get a long preamble (500ms) in the radio frame. In this case, it is necessary to activate the LMP mode at 500ms by doing the procedure of shunting in the electronic card as below :

1. **On Situo 5 io / RTS, select your channel.**
2. **Remove the back cover by unscrewing on the back side**
3. **Make a contact between the two dedicated areas on the PCB for 2 seconds**

Note: If you press less than 2 secs, you will see the current mode:
blinking = autonomous actuators activated
Fix lighting = autonomous actuators deactivated

