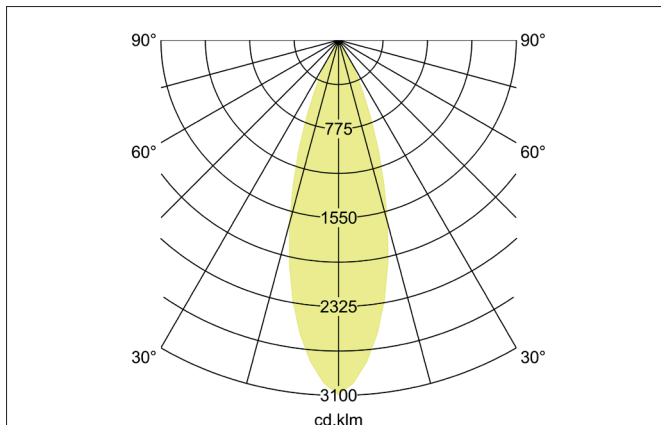
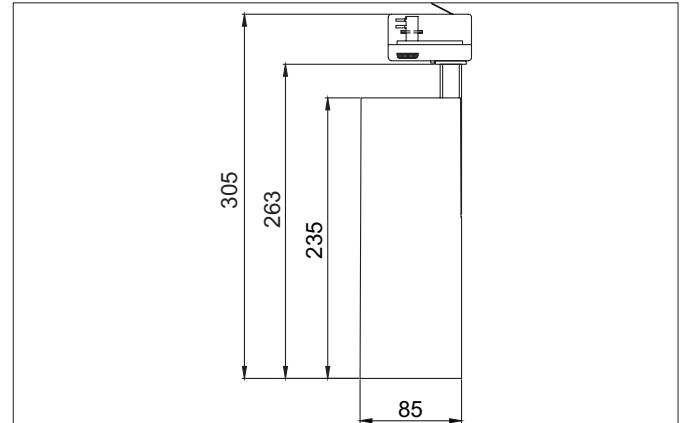

MAXI LED track spotlight

Article no. 88397683

Light.
For Generations.**Tender**

LED track spotlight, Round. Ceiling cut-out Installation depth mm, Outer diameter 85 mm, Weight 1,269 kg, with rotationssymmetrical, deep, wide distributed light intensity. Luminous flux 4.010 lm, Power 1 x 31,5 W, Light colour warm white, Correlated color temperature (CCT) 3.000 K, Colour rendering index CRI > 90, Housing material: Aluminium, Colour: Silver structure, Permissible ambient temperature (ta): -20 °C - +25 °C, Protection class (EN 61140): I, Degree of protection (DIN EN 60529): IP20, .With electronic driver, on/off switchable.

| Article data | |
|-------------------|--------------------------|
| Article no. | 88397683 |
| GTIN | 4251433947493 |
| Series name | MAXI |
| Short description | LED track spotlight |
| Material | Aluminium |
| Colour | Silver |
| Type of surface | Structure |
| Shape | Round |
| Outer diameter | 85 mm |
| Length | 235 mm |
| Width | 85 mm |
| Hight | 263 mm |
| Scope of delivery | incl. driver, switchable |
| Weight | 1.269 kg |

MAXI LED track spotlight

Article no. 88397683

Light.
For Generations.

| Lighting technology | |
|------------------------------|------------|
| Colour temperature | 3.000 K |
| Light colour | White |
| Luminous flux | 4,010 lm |
| System efficiency | 127 lm/W |
| Colour rendering | CRI > 90 |
| Reflector | High-gloss |
| Beam angle | 30° |
| Light sharing | Symmetric |
| Adjustable color temperature | No |

| Operating technology of the luminaire | |
|---------------------------------------|--|
| System output | 31.5 W |
| Voltage type | AC |
| AC nominal voltage max | 230 V |
| Frequenz max. | 50 Hz |
| Lamp | LED |
| Lamp holder | Without fitting |
| Protection class | I |
| Degree of protection | IP20 |
| Control | on/off |
| Bulb change possible | The light source of this luminaire may only be replaced by the manufacturer or a service technician commissioned by him or a similarly qualified person. |





| Mounting technology | |
|-----------------------------|-------------------------------|
| Mounting method | Surface mounting |
| Place of installation | Ceiling-mounted |
| Adjustability | Rotatable and adjustable head |
| Swivel angle | 180° |
| Rotation angle | 350° |
| Head adjustable angle | 90° |
| Suitable for through-wiring | No |

| Packing data | |
|-------------------------|---|
| Gross weight | 1.395 kg |
| Length of packaging | 300 mm |
| Packaging width | 200 mm |
| Packaging height | 150 mm |
| Disposal at end of life | This product must not be disposed of with household waste. You are obliged, to dispose of such electrical waste separately. By disposing of electrical waste and other old or defective electronics separately, you support recycling or other forms of re-use. In that way you help to take care and to avoid that harmful substances get into the environment. |

MAXI LED track spotlight

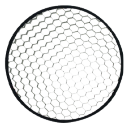
Article no. 88397683

Light.
For Generations.

| Accessories | |
|--|---|
|  | <p>Article no.: 8 1397 182 Honeycomb grid for spot MAXI</p> |
|  | <p>Article no.: 8 1397 171 Schade for spot MAXI</p> |
|  | <p>Article no.: 8 1397 181 Schade for spot MAXI</p> |
|  | <p>Article no.: 8 1397 180 Glare protection for spot MAXI</p> |
|  | <p>Article no.: 8 1397 170 Glare protection for spot MAXI</p> |