

Transfer or duplication of this document as well as the utilisation or communication of its content are not permitted unless express consent is granted. Violations give rise to claims for damages. All rights reserved in case of patent, utility model or design patent registrations.

Weitergabe sowie Vervielfältigung dieses Dokuments, Verwertung und Mitteilung seines Inhalts sind verboten, soweit nicht ausdrücklich gestattet. Zuwiderhandlungen verpflichten zu Schadensersatz. Alle Rechte für den Fall der Patent-, Gebrauchsmuster- oder Designeintragung vorbehalten.

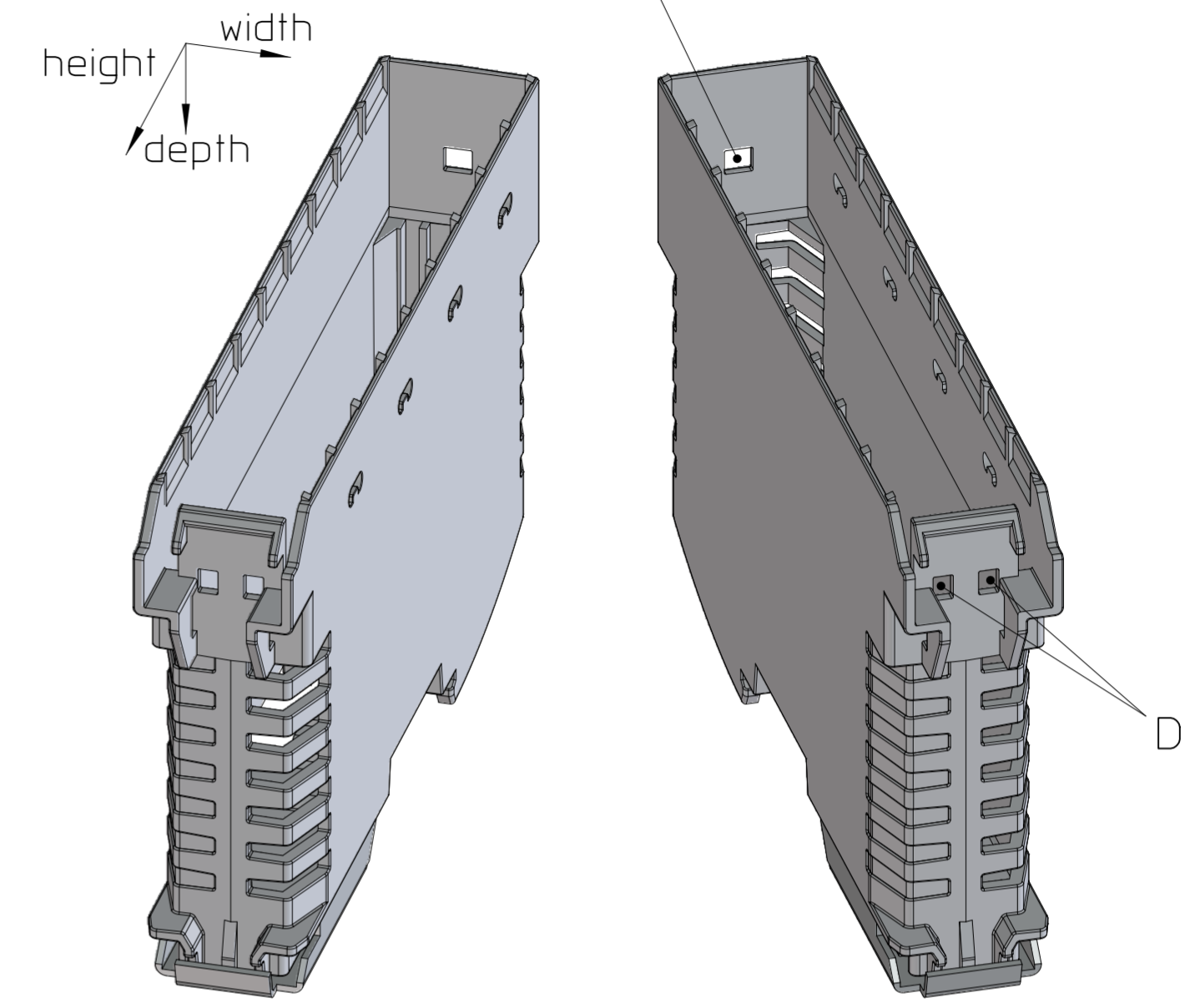
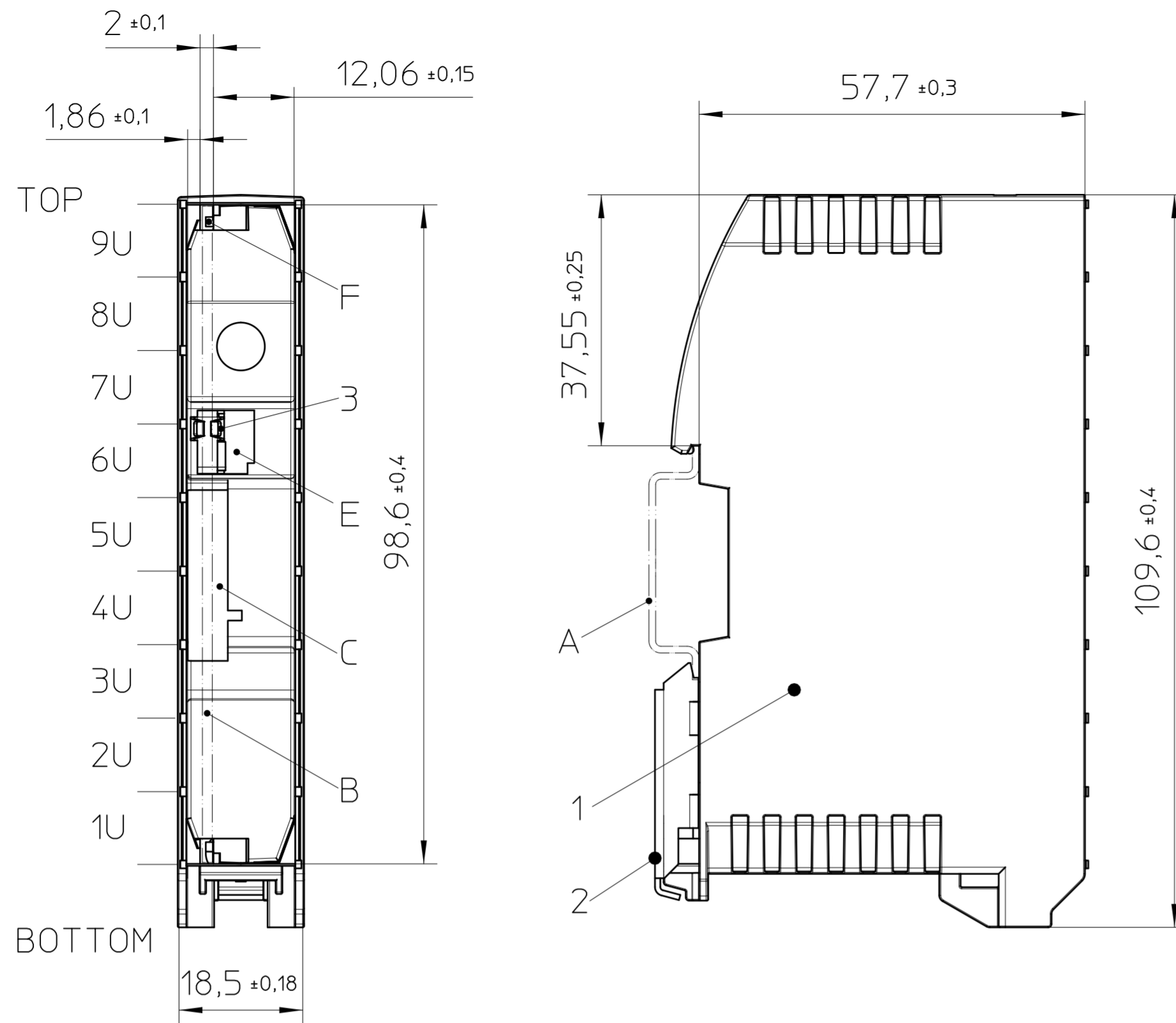

General Information:

- Simplified representation
- Document excluded from change process
- Units are in millimeters [mm] and degrees [°]
- Tolerances apply in a normal climate according to DIN EN ISO 291-23/50-2, PA plastic parts with about 2% (% by weight) moisture content.
- Web: www.phoenixcontact.com webcode: #1635
- In case of distortion there is no functional impact of the single part in the application.

Additional Information:

- A. Mounting rail like EN 60715, TH 35-7,5 or mounting rail similar EN 60715, TH 35-15x1,5
- B. PCB t=1,6±0,2
- C. Guidance slot for TBUS . . .
- D. Opening for fixing ME-IO Cover . . .
- E. Opening for ME BUS FE CONTACT
- F. PCB Fixing

ME-IO 18,8 B 10U TBUS			
Pos.	QTY	Description	Matreial
1	1	HOUSING	PA
2	1	FOOT CATCH with SPRING	STL
3	1	FE-CONTACT	STL

DIN A3	document-No. / RI	date	scale
	00760356 / 03	28.04.2025	1:1
	ident.-No.	document-type	
	2201809	TECDOC 2D_Productdrawing	
page 1	of 2	description	
		ME-IO 18,8 B/FE 9U TBUS 7035	

Marking area

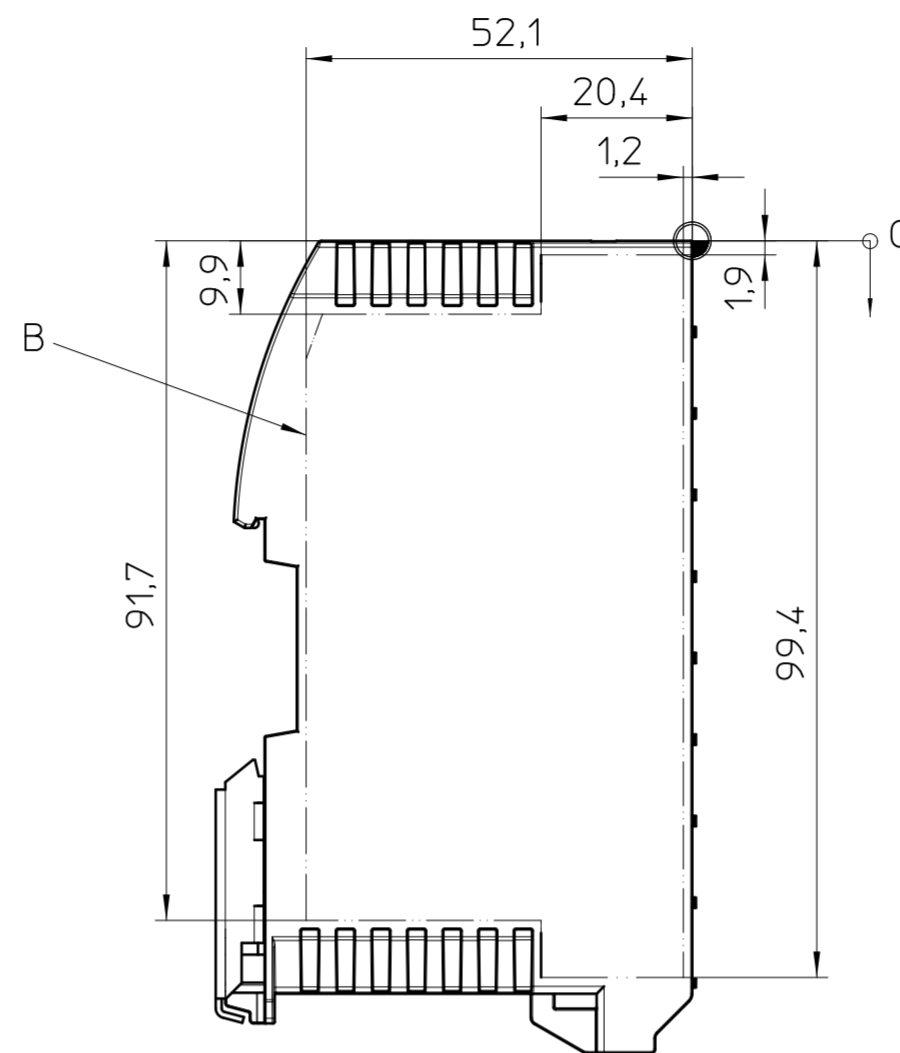
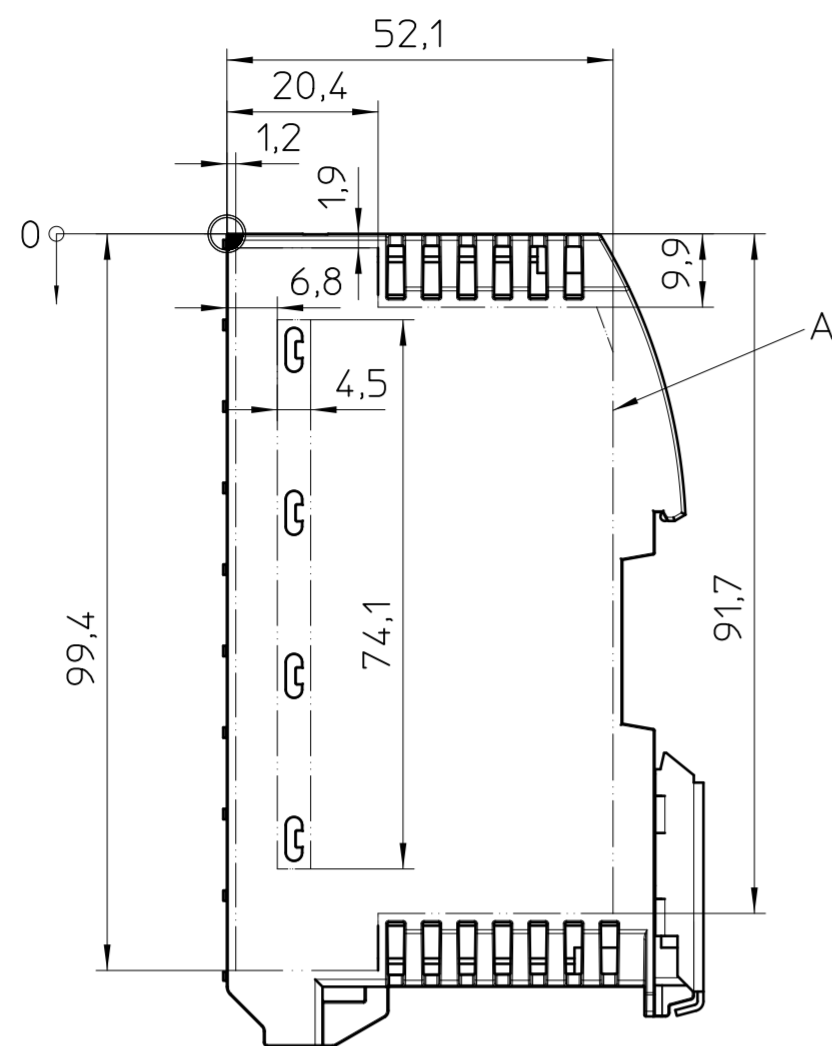

Machining area

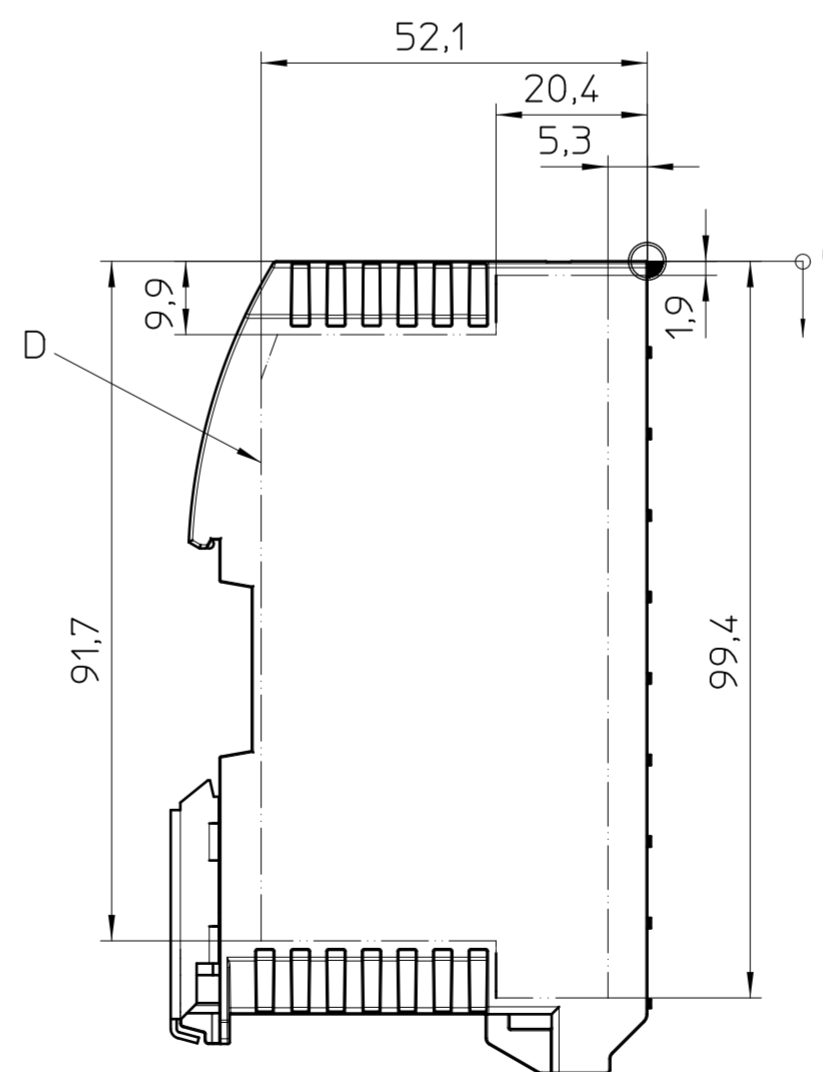
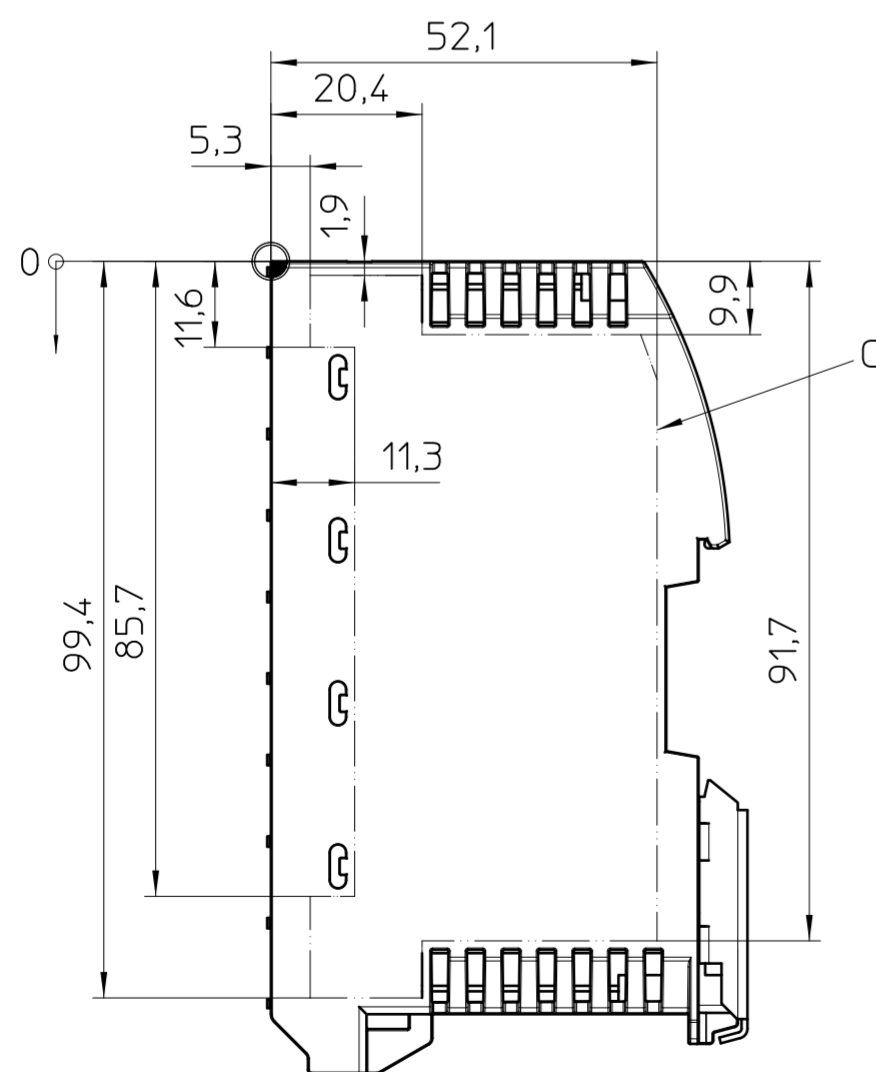

General Information:

- Simplified representation
- Document excluded from change process
- Units are in millimeters [mm] and degrees [°]
- Tolerances apply in a normal climate according to DIN EN ISO 291-23/50-2, PA plastic parts with about 2% (% by weight) moisture content.
- Workpiece zero point for mechanical processing
- Tolerances for marking and machining DIN ISO 2768-m
- For milling > 50% of the machining area, the machinability should be verified.
- In case of distortion there is no functional impact of the single part in the application.
- Web: www.phoenixcontact.com webcode: #1635

Additional Information:

- A. Max. marking area right
- B. Max. marking area left
- C. Max. machining area right
- D. Max. machining area left

Transfer or duplication of this document as well as the utilisation or communication of its content are not permitted unless express consent is granted. Violations give rise to claims for damages. All rights reserved in case of patent, utility model or design patent registrations.

Weitergabe sowie Vervielfältigung dieses Dokuments, Verwertung und Mitteilung seines Inhalts sind verboten, soweit nicht ausdrücklich gestattet. Zuwiderhandlungen verpflichten zu Schadensersatz. Alle Rechte für den Fall der Patent-, Gebrauchsmuster- oder Designeintragung vorbehalten.

	DIN A2	document-No. / RI 00760356 / 03	date 28.04.2025	scale 1:1
	ident.-No. 2201809	document-type TECDOC 2D_Productdrawing	description ME-IO 18,8 B/FE 9U TBUS 7035	
page 2	of 2			