

# Montage Wandaufbauadapter/ Wall mounting adaptor FMWA001

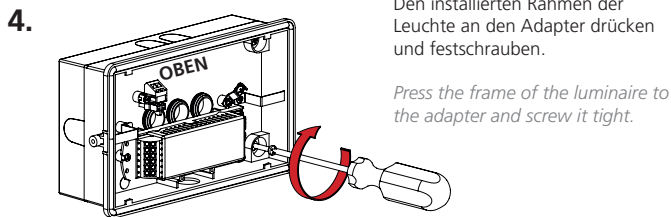
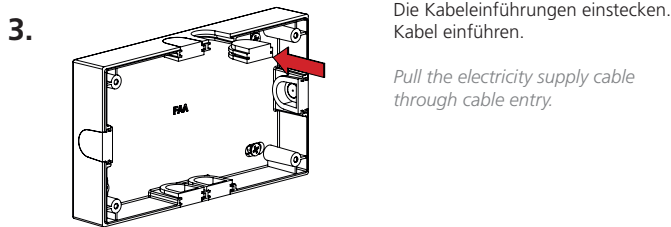
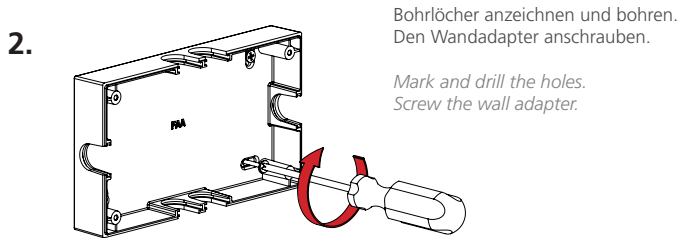
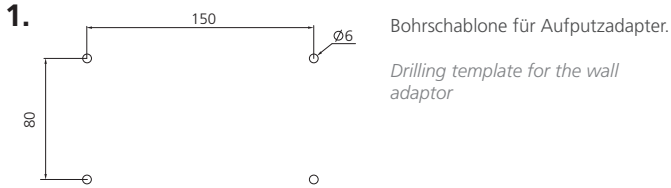

## FlexWay

Wand- und Deckenaufbauadapter  
*Wall- and ceiling mounting adaptor*

FMDA001 / FMDA002 / FMWA001

# Montage Deckenaufbauadapter/ ceiling mounting adaptor FMDA001 / FMDA002

1.

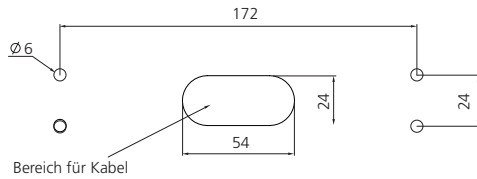

Bohrschablone für Deckenaufbauadapter.

*Drilling template for the ceiling adaptor*

2.

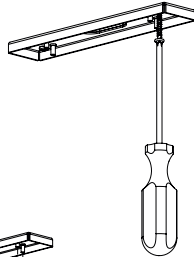

Bohrlöcher anzeichnen und bohren.  
Die Grundplatte anschrauben.

*Mark and drill the holes.  
Screw the base-plate.*

3.

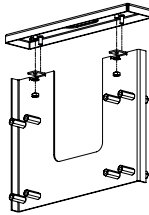

Mittelplatte anschrauben.

*Screw the medium-plate.*

4.

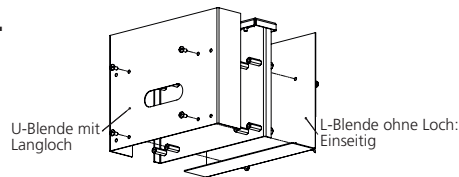

## Einseitige Flexway:

Anschlusskabel durch das Langloch der U-Blende führen. Anschließend U-Blende mit den vier innenliegenden Schrauben montieren. Danach L-Blende mit den vier Schrauben fixieren.

*One-sided Flexway:*

*Pull the connection cable through the slot of the U-profile. Then mount the U-profile with the four internal screws. After that fix the L-profile with the four screws.*

5.

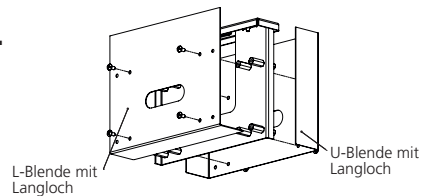

## Zweiseitige Flexway:

Anschlusskabel auf beiden Seiten durch die Langlöcher führen. Anschließend U-Blende mit den vier innenliegenden Schrauben montieren. Danach L-Blende mit den vier innenliegenden Schrauben fixieren.

*One-sided Flexway:*

*Pull the connection cable on both sides through the slot of the U-profile. Then mount the U-profile with the four internal screws. After that fix the L-profile with the four screws.*

6.

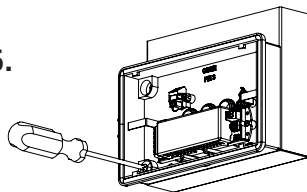

Elektronikgehäuse der Flexway an den Deckenadapter anschrauben.

*Screw the electronic enclosure of the flexway on the ceiling-adaptor.*