

EnOcean Easyclickpro flush-mounting receiver, 2-channel

Product Data Sheet

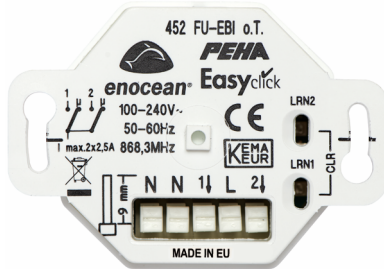

In housing	Yes
bi-directional	yes
Push button mode	Yes
Switching mode	Yes
With radio controlled push button	No
Number of relays	2
2 channel	yes
Halogen free	Yes
potential-free contact	no
1 channel	no
with mounting plate	no
position detection	no
Radio frequency	868Megahertz
energy metering	no
Current supply	230 V AC
Mounting method	Flush mounted (plaster)
Type of fastening	Mounting with screw
Colour	White
Suitable for degree of protection (IP)	IP20
information1	switch

Empfänger Easyclick

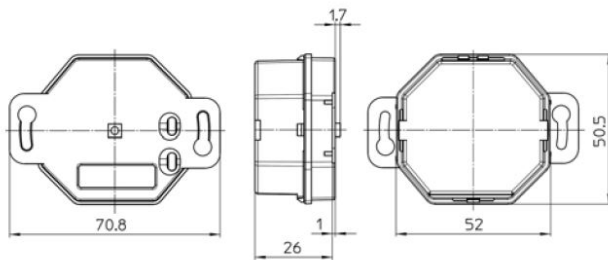

EnOcean Easyclickpro flush-mounting receiver, 2-channel

The bidirectional Easyclick receiver can not only receive radio signals, but also transmits back its status every time it changes. Actual ON/OFF switched states can then be visualised e.g. on the handheld transmitter D 450 FU-HS 128. The Easyclick receiver serves to switch lights and other electrical consumers. A range of functions and parameters can be selected:

- two-key operation ON/OFF (standard function)
- one-key operation ON/OFF (changeover)
- button operation (pulse)
- hotel card switch with definable follow-up time
- stairwell light with selectable running time and shutdown warning
- automatic OFF after selectable running time
- fan function with delayed ON and with selectable follow-up time
- save and retrieve 4 lighting scenes at the press of a key (one lighting scene per key)
- window handle and window contact, visualisation also parallel to the switching outputs
- movement detector and light sensor
- A function can be defined individually for each of the max 32 programmed transmitters
- Integrated repeater functions (1 level / 2 level) can be switched ON for each project, irrespectively of the set functions
- Separate preassigned functions and parameters when e.g. window contacts, window handles, and movement detectors are being programmed

Technical data:

Own consumption: < 0.5 W (bistable relays)

Transmit frequency: 868.3 MHz

Voltage supply: 100-240 Vac/ 50-60 Hz

Neutral conductor: required

Ambient temperature: -20 °C to +40 °C

Storage temperature: -40 °C to +85 °C

Plugin terminals: max 1 x 1.5 mm²

Housing height: 28 mm

Rating: IP 20

Mounting lugs: for screwing down in switch sockets

Approvals: CE; KEMA/KEUR

Load types 230 Vac (110 Vac)

Incandescent lamps 500 W (250 W)

HV halogen lamps 100 W (50 W)

Motor load 100 VA (50 VA)

EVG load 1 pcs (1 pcs)

The quantity depends on the type and manufacturer. The devices data sheet must be observed!

Material No.

Article No.

EAN-code

00364336

D 452 FU-EBI O.T.

4010105364330

PEHA Elektro GmbH & Co.KG

a Honeywell Company
Daimlerstraße 4
58553 HALVER
DEUTSCHLAND

Tel.: 02353 9118 001
Fax: 02353 9118 311
mail: peha@honeywell.com
www.peha.de

Änderungen vorbehalten. © Honeywell PEHA