

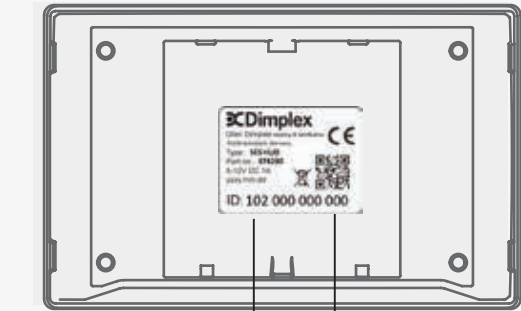

<http://www.dimplex.digital/scs>

ID



ID code
ID QR-code

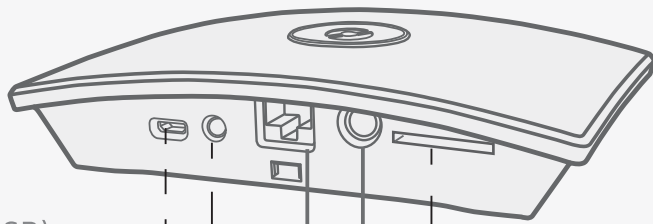

(MicroUSB)
(RS232)
Ethernet
5-12V DC
(SD mini)



RF 868,4 MHz
≤10 mW

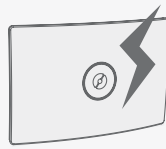

5-12VDC
max 300mA



IP20



max +35°C

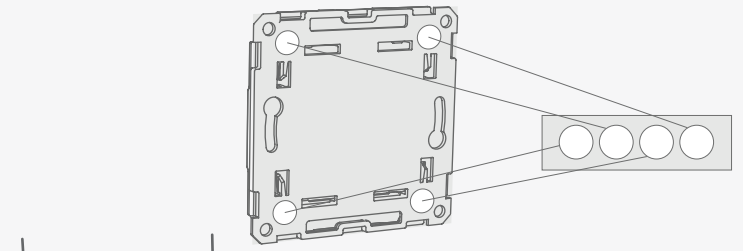

60mm

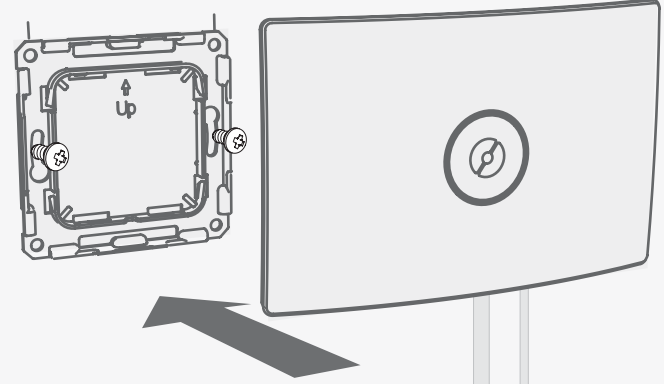

Dieses Gerät darf nur an die mit dem Gerät
gelieferte externe Stromversorgung
angeschlossen werden
This unit must only be connected to the
external power supply supplied with the
equipment

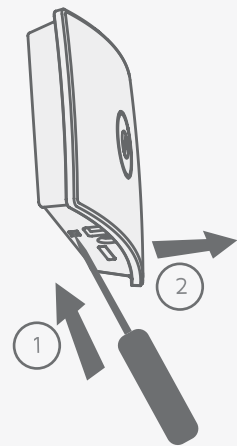

Euro plug	AC / DC adaptor, 100-240V ac / 9Vdc 0.6A DC cable 1.5m w/ 5.5x2.5x12mm plug	YS6-0900600E
-----------	--	--------------

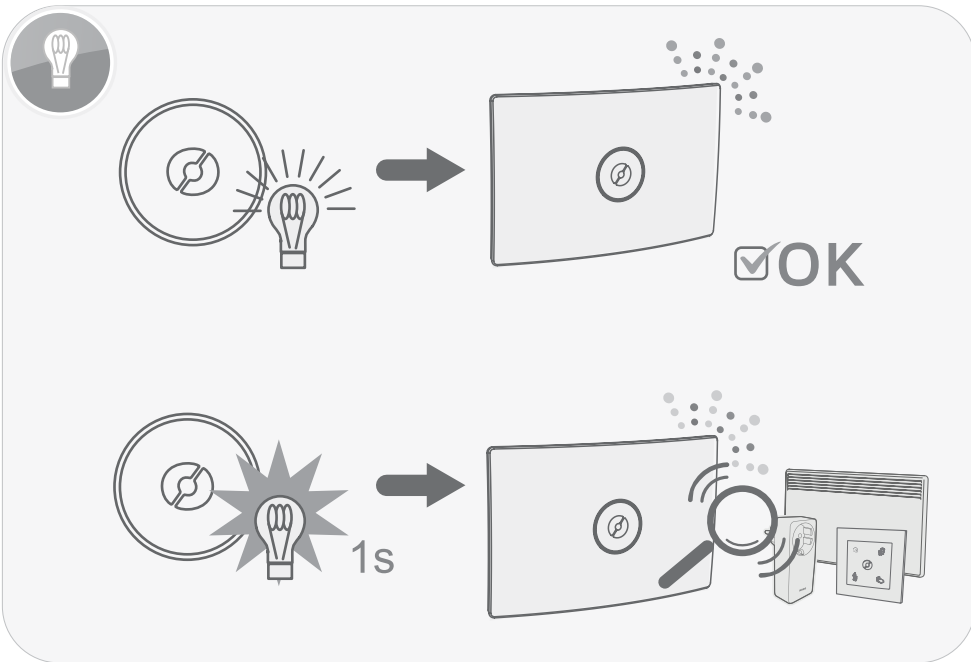

Dimplex

SCS HUB

Smart Climate HUB



User guide
Benutzerhandbuch

KONFORMITÄTSERKLÄRUNG.

Glen Dimplex Heating & Ventilation erklärt, dass die in dieser Bedienungsanleitung (SCS HUB) beschriebenen Geräte den grundlegenden Anforderungen und anderen relevanten Bestimmungen der EU-Richtlinie 2014/53 / EU entsprechen. Wenn Sie eine Kopie des originalen unterschriebenen DoC benötigen, senden Sie bitte eine E-Mail an: info@gdhv.one

DECLARATION OF CONFORMITY.

Glen Dimplex Heating & Ventilation declares that the equipment described in this user guide (SCS HUB), is in compliance with the essential requirements and other relevant provisions of EU Directive 2014/53/EU. If you require a copy of the original signed DoC, please send an E-mail to: info@gdhv.one

GlenDimplex

Glen Dimplex Deutschland GmbH
 Division GDHV
 Am Goldenen Feld 18 | D-95326 Kulmbach | Germany
www.dimplex.digital/scs
info@gdhv.one

1x

1x

1x

1x

1x

1x

Dimplex Energy Control

ANDROID APP ON

Available on the

<https://www.dimplex.digital/scs>