

System M

System M controller

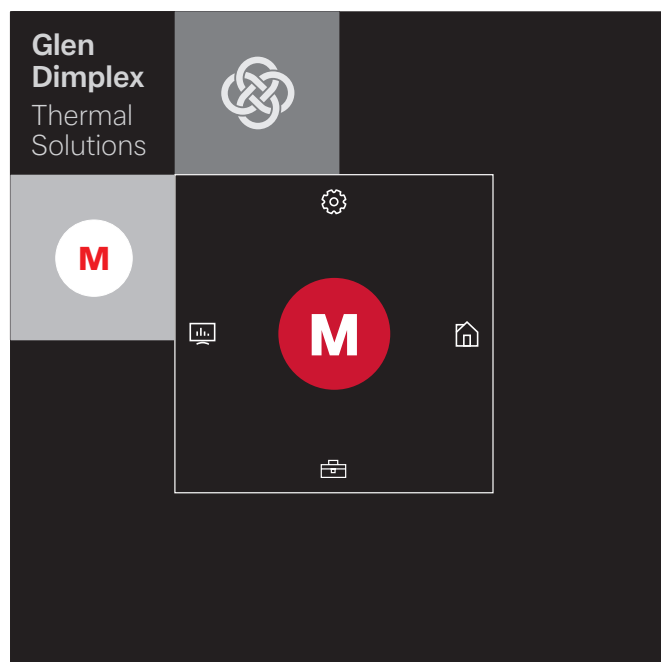

Installation and Operating Instruction

Controller for Air-to-water
heat pump
in integral design

Table of contents

1	Unit type selection	2
1.1	Heat pump “with touch panel”	2
1.2	Heat pump “with status panel”	2
2	Setting up the GDTs Home app for the heat pump “with touch panel”	3
3	Setting up the GDTs Home app for the heat pump “with status panel”	5
4	Logging in using a smart device (e.g. smartphone)	7
4.1	Logging in	7
4.2	Start screen	7
5	Logging in using the touch panel	8
5.1	Logging in	8
5.2	Start screen	8
6	Commissioning and operating the heat pump	9
6.1	General.....	9
6.2	Commissioning as a specialist.....	9
6.3	User settings.....	10

1 Unit type selection

1.1 Heat pump “with touch panel”

i NOTE

Commissioning and operation using the touch panel siehe Kap. 5 auf S. 8

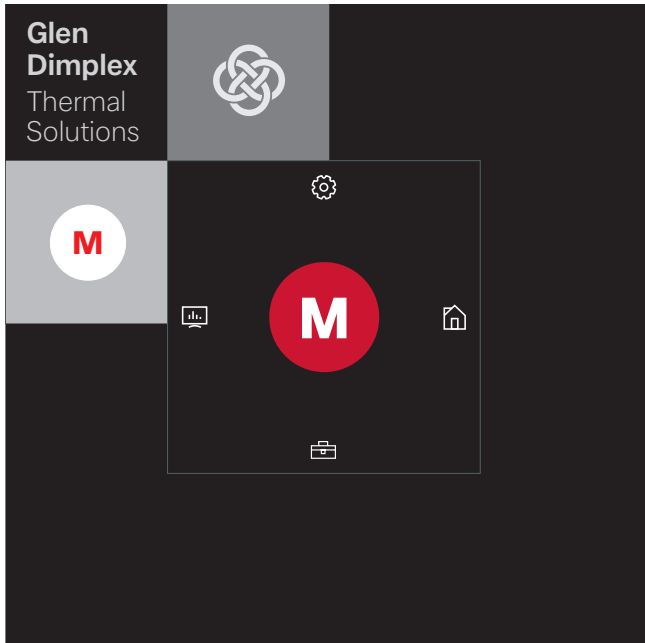

However, commissioning and operation can also be carried out using a smart device paired with the unit, such as a smartphone with the GDTS Home app. In order to commission the unit using a smartphone, you will first need to set up the app as described in Cap. 2 on page 3.

1.2 Heat pump “with status panel”

i NOTE

Commissioning and operation only possible via smartphone, siehe Kap. 4 auf S. 7.

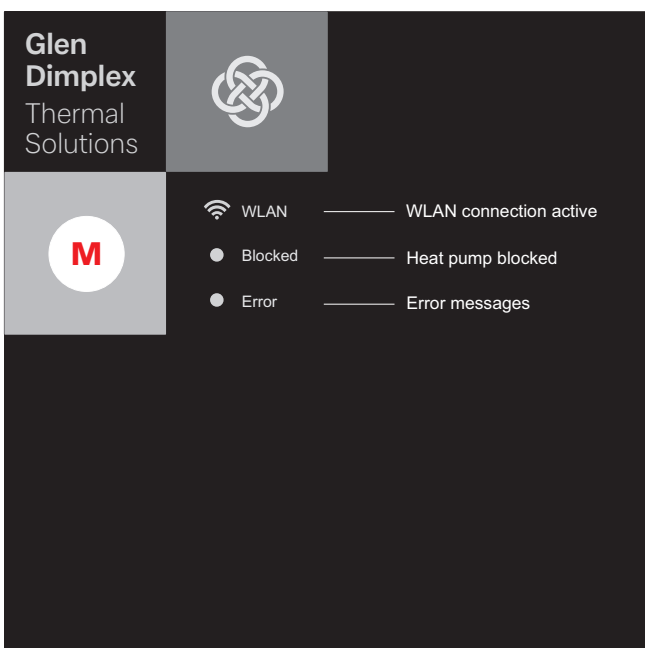

The heat pump “with status panel” can only be commissioned and operated using a smart device paired with the unit, such as a smartphone with the GDTS Home app. In order to do this, this app must first be set up on the smartphone in question. Instructions for setting up the app are provided in Cap. 3 on page 5. Once this is done, the heat pump can be commissioned.

2 Setting up the GDTS Home app for the heat pump “with touch panel”

As an option, the heat pump can be commissioned and operated using a smart device, such as a smartphone. In order to allow this, the corresponding app must first be downloaded onto the device via the smartphone provider’s download portal.

Search term: GDTS home app

System requirements: Android 6.0 or iOS 10

Proceed as follows:

- 1) Open the GDTS Home app.
Confirm the start screen: tap on the tick.
- 3) Select a system type. “With touch panel”

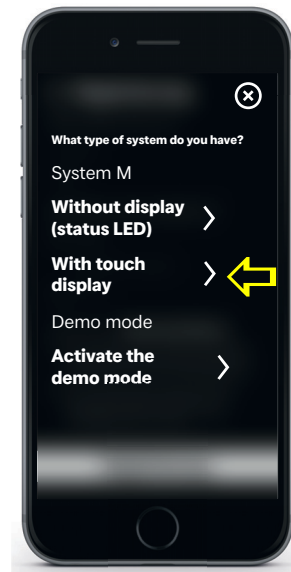
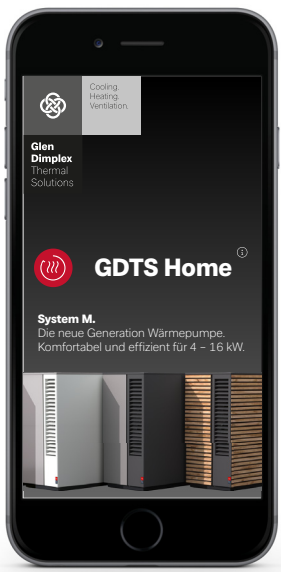

- 2) Register: tap “Register now”.
Enter your e-mail address and password.
Tap “Register”.

- 4) Using the heat pump’s touch panel, select “Settings” followed by “Register”. Press the Registration Code button to request the UID PIN.

i NOTE

The password must contain at least 8 characters.

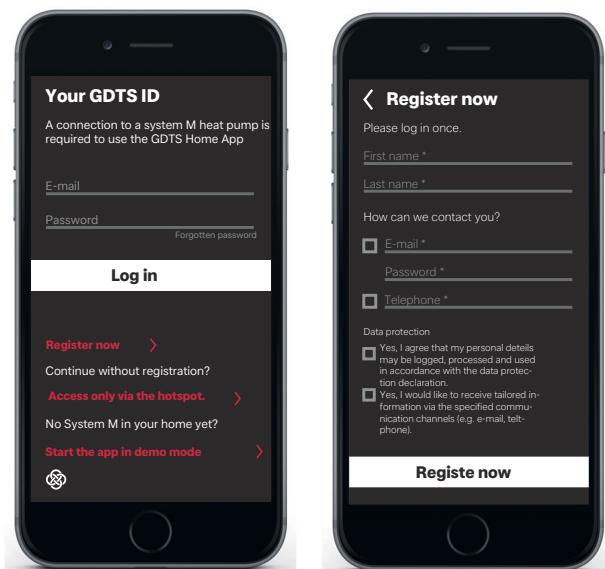

Software update	Screen lock	Date and time
OK	5 min	Automatic
Individual adjustments Room assignment Profile	Wireless hotspot	Network
	off	OK
Language and region	Manufacturer contact	Register now
English		Logged in Betreiber

- 5) The UID PIN will appear on the display. This pin will remain active for 10 minutes.

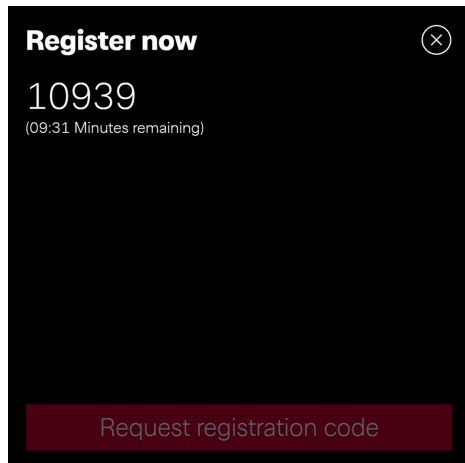

- 7) The display will indicate whether or not the device has been added successfully. The system can be renamed. To rename the heating system, tap on the pencil icon. Once you are done, tap "Finish". When you tap on the system name, the screen will change to the clock display.

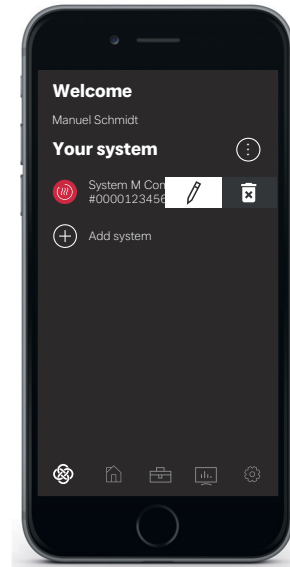

- 6) Enter the UID PIN shown on the display into your smartphone. Tap "Verify code".

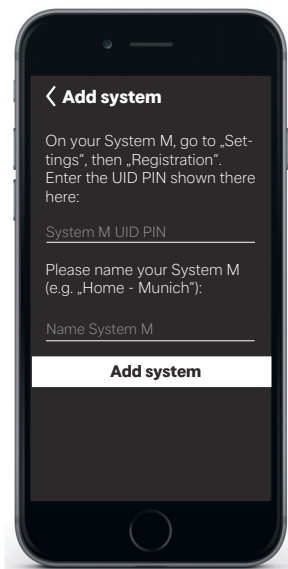

The system can now be commissioned and operated via the GDTS Home app as described in Cap. 4 on page 7.

3 Setting up the GDTS Home app for the heat pump “with status panel”

The heat pump can only be commissioned and operated using a smart device. In order to allow this, the corresponding app must first be downloaded onto the device via the smartphone provider's download portal.

Search term: GDTS home app

System requirements: Android 6.0 or iOS 10

Proceed as follows:

- 1) Open the GDTS Home app.
Confirm the start screen: tap on the tick.
- 3) Select a system type. “With status panel (status LEDs)”

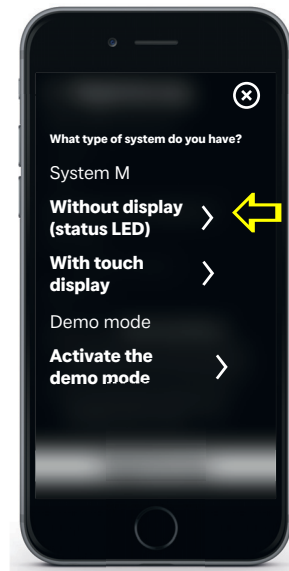
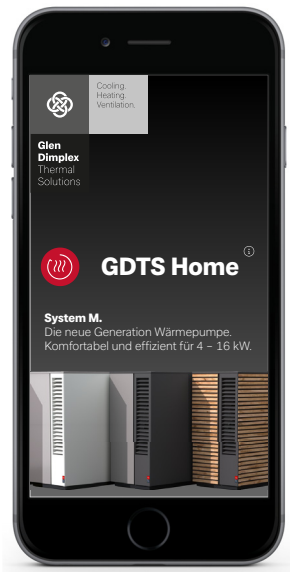

- 2) Register: tap “Register now”.
Enter your e-mail address and password.
Tap “Register”.

i NOTE

The password must contain at least 8 characters.

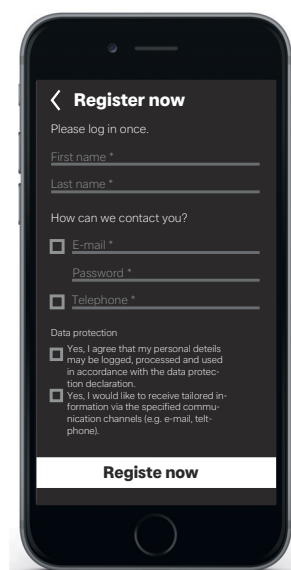
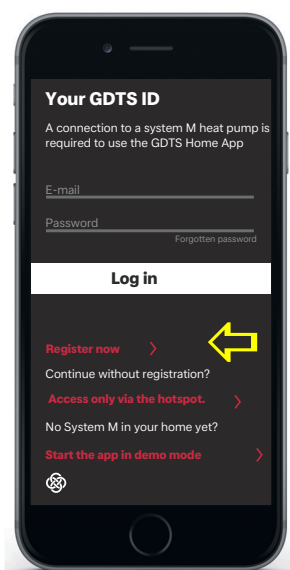

- 4) On the heat pump's status panel, tap the “M” icon. The local Wi-Fi connection process will be activated. This process may take up to 60 seconds. Once connection is successful, the Wi-Fi display indicator will light up.

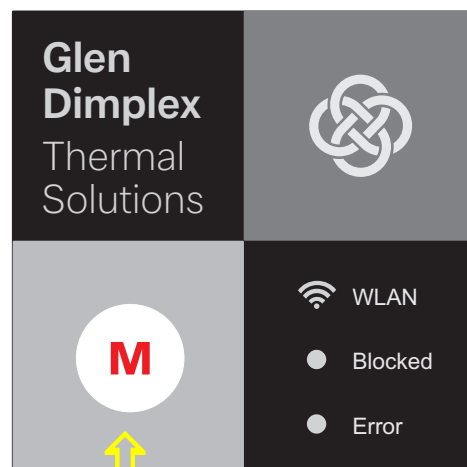

- 5) Once this is done, start the connection process. During the connection process, the individual steps will be shown on the display of your smartphone. Acknowledge by tapping on the tick.

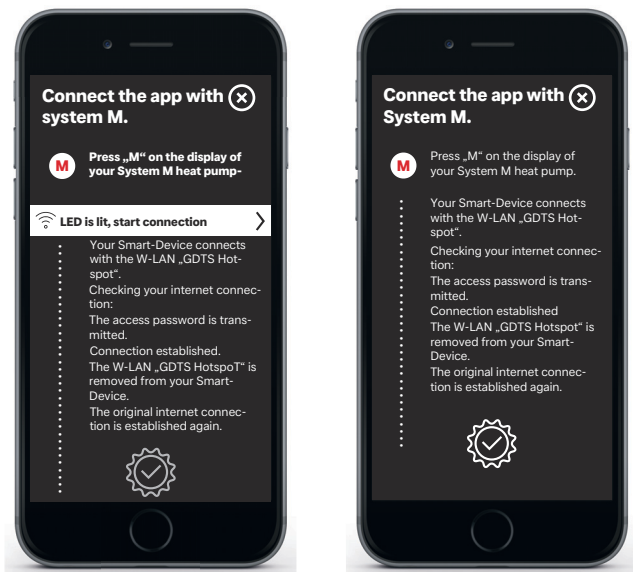

- 6) The system can now be renamed. To rename the heating system, tap on the pencil icon. Once you are done, tap “Finish”. When you tap on the system name, the screen will change to the clock display.

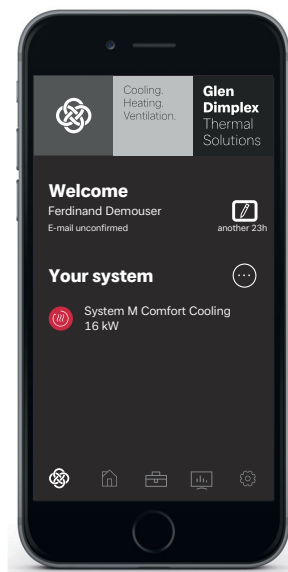

The system can now be commissioned and operated via the GDTS Home app as described in Cap. 4 on page 7.

4 Logging in using a smart device (e.g. smartphone)

4.1 Logging in

Switch on

Enable:

M = User

I = Specialist

Specialist: Enter password
systemm

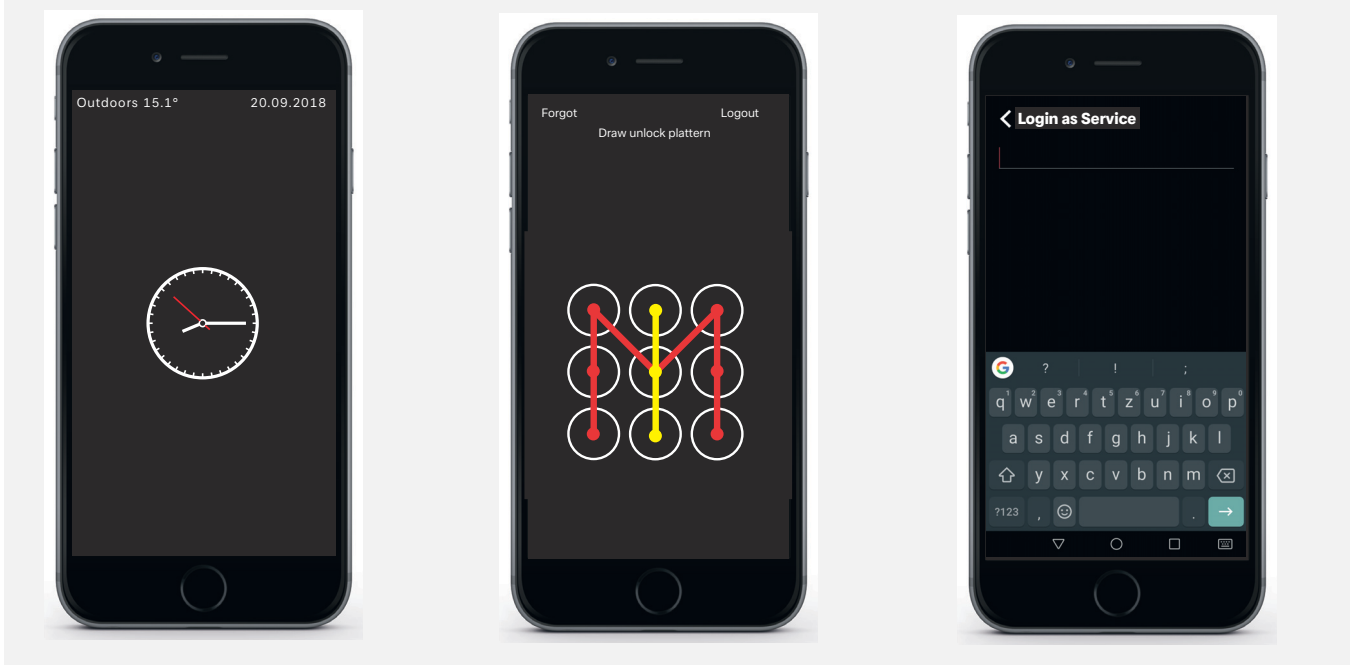

4.2 Start screen

Menu selection

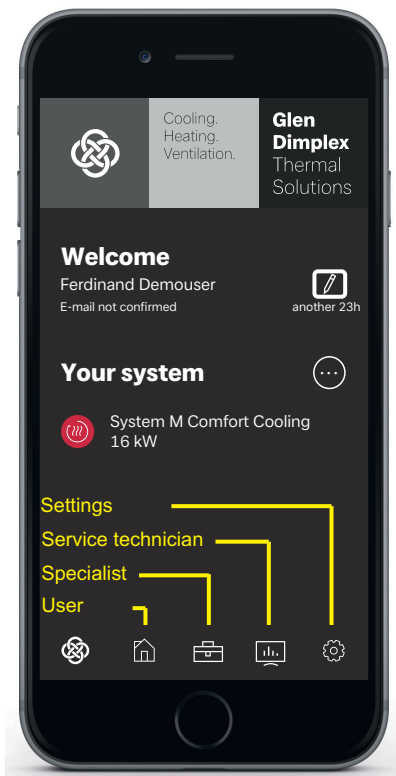

i NOTE

Once you have logged in and opened the start screen, you will be able to commission and operate the system using your smartphone in the same way as you would with the touch panel (siehe Kap. 6 auf S. 9).

5 Logging in using the touch panel

5.1 Logging in

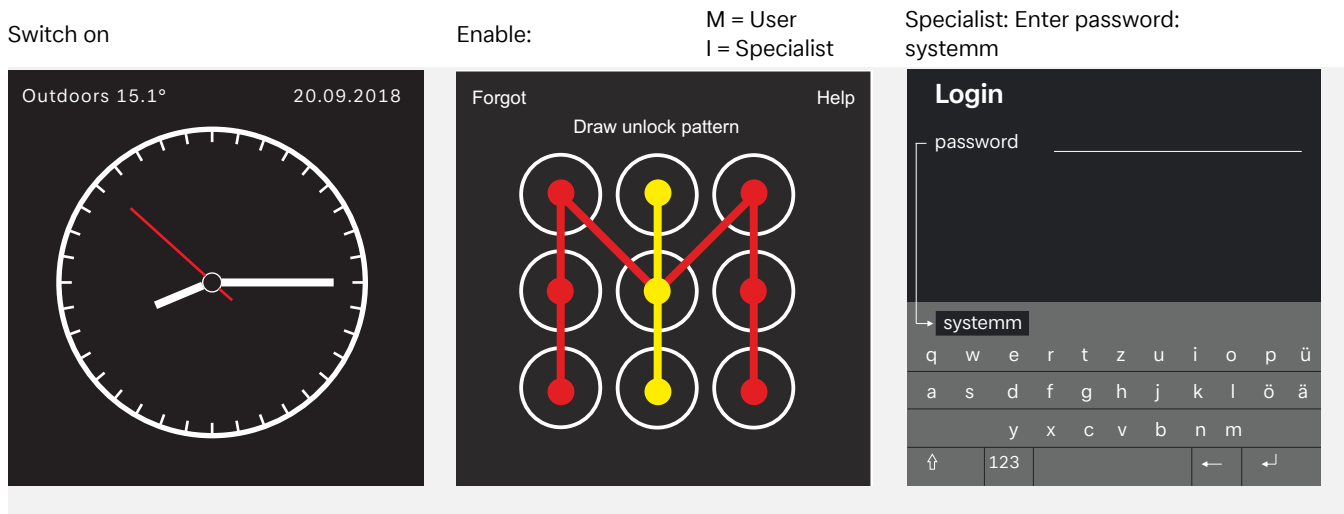

5.2 Start screen

Menu selection

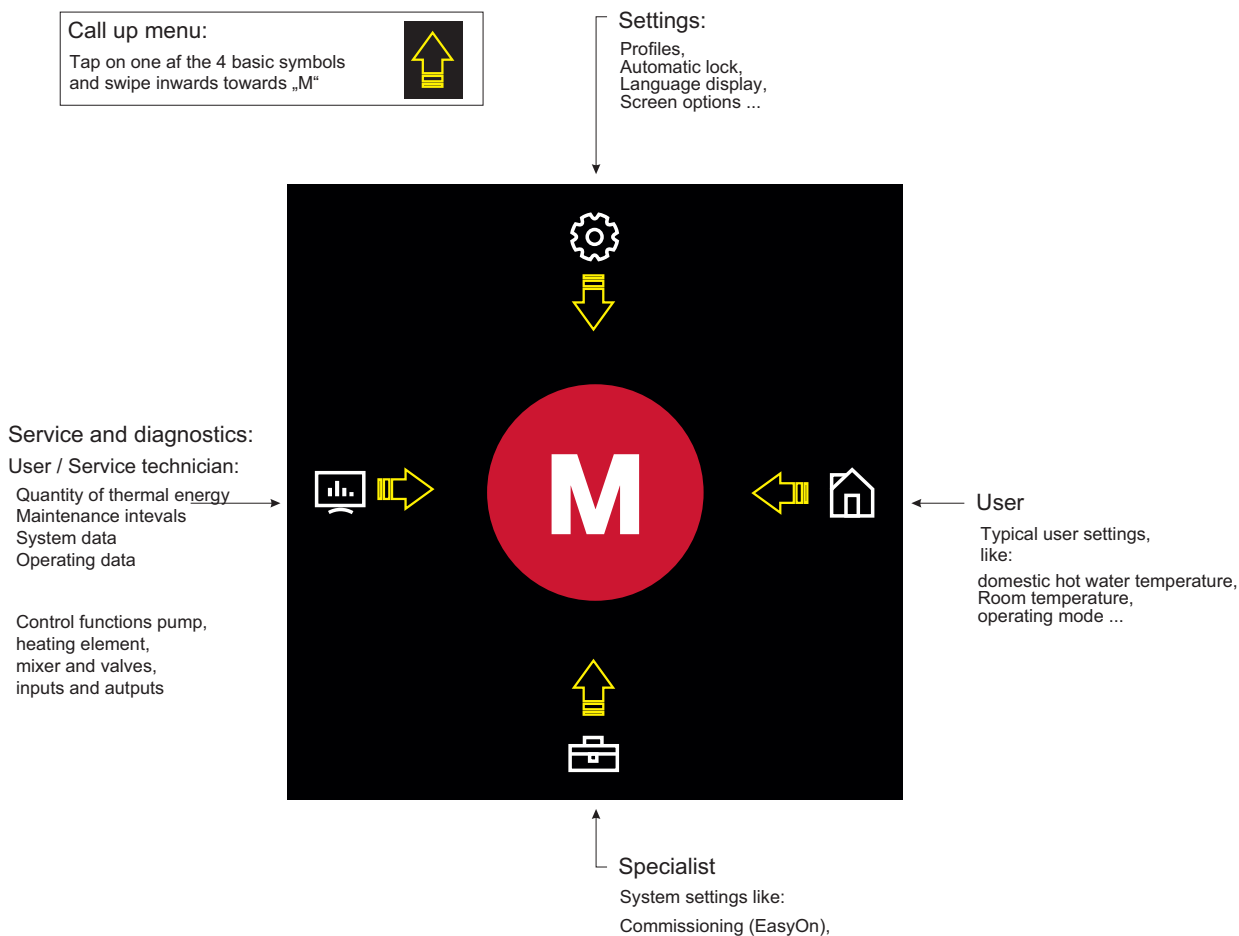

i NOTE

Commissioning and operating the heat pump using the touch panel siehe Kap. 6 auf S. 9

6 Commissioning and operating the heat pump

6.1 General

Once you have logged in and opened the start screen (siehe Kap. 5 auf S. 8), you can commission and operate the system using the touch panel.

i NOTE

Once you have logged in and opened the start screen (siehe Kap. 4 auf S. 7), you will be able to commission and operate the system using your smart device in the same way as you would with the touch panel.

6.2 Commissioning as a specialist

Select the Specialist menu option

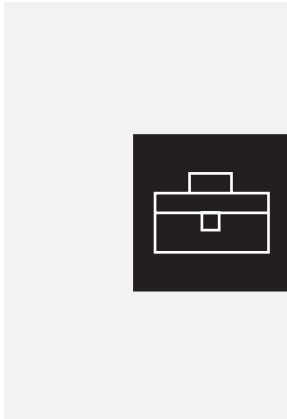

Select Commissioning (EasyOn set-up)

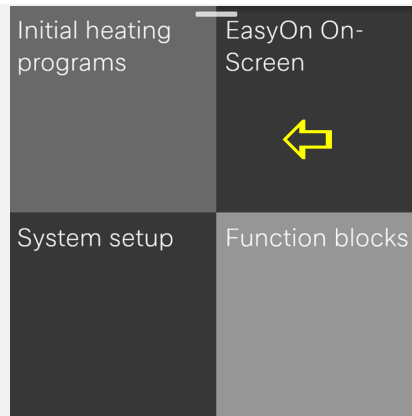

Operating mode is shown

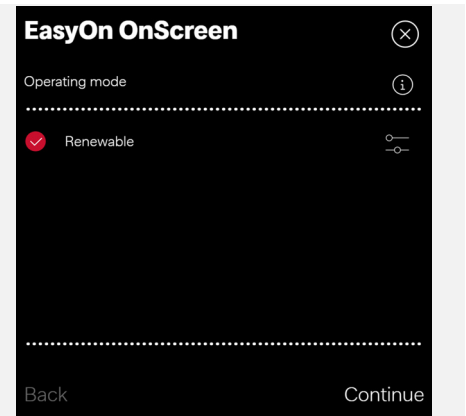

Example help screen

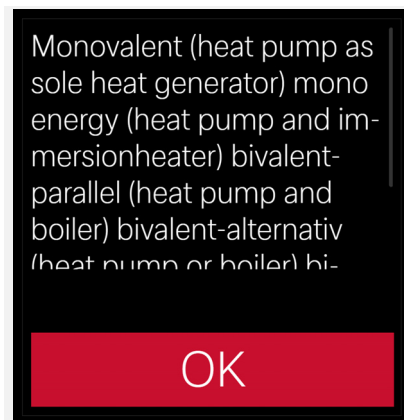

Additional commissioning steps ...

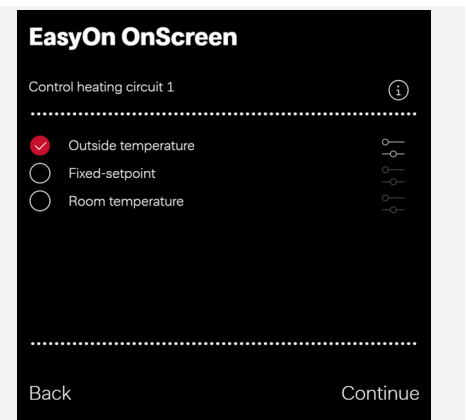
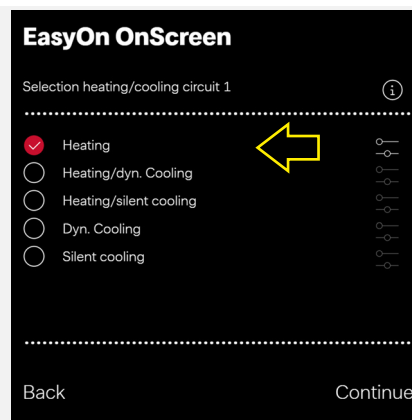

Select the Settings menu option

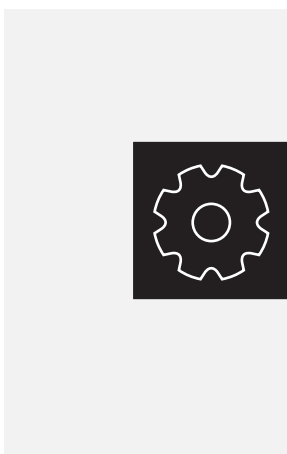

General overview

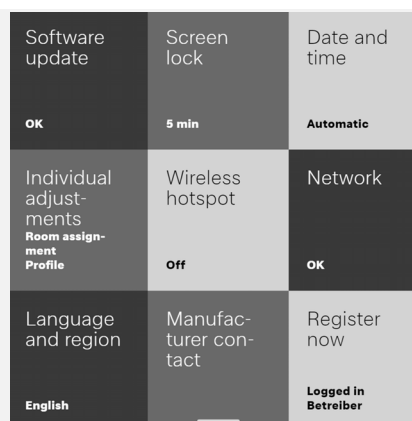

Example: Automatic block on/off

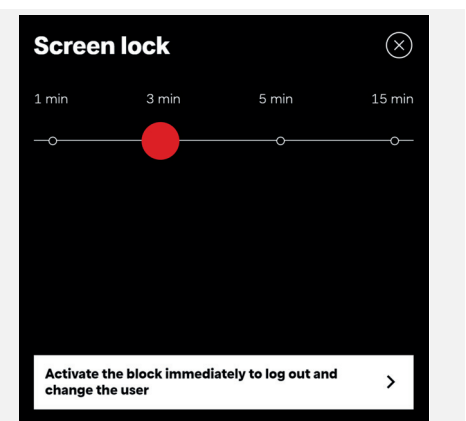

6.3 User settings

Select the User menu option

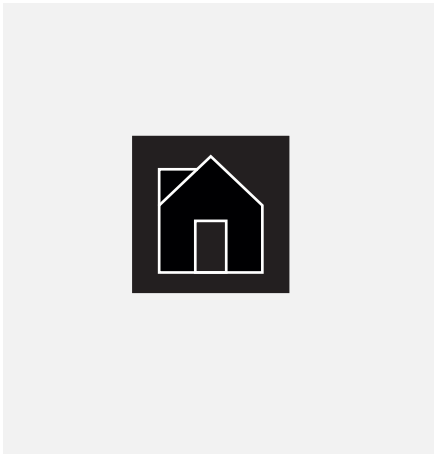

Example: Select domestic hot water

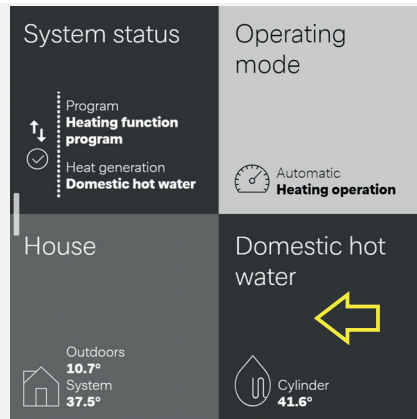

Change hot water temperature



Select the User menu option

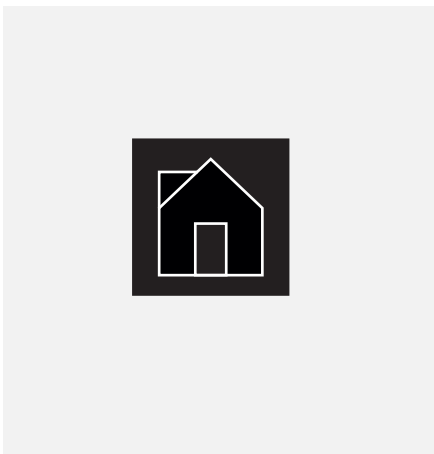

Example: Select room temperature

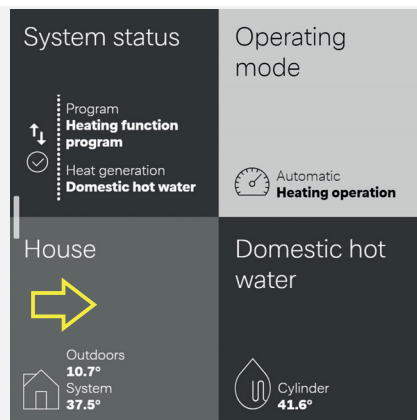

Change room temperature

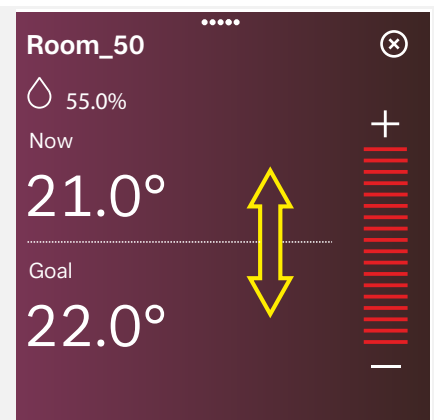

Select the Settings menu option

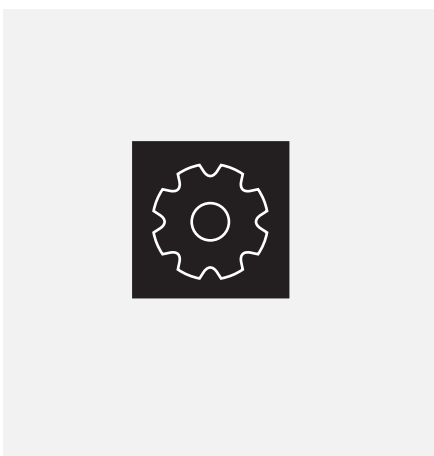

General user overview



Example: Automatic block on/off

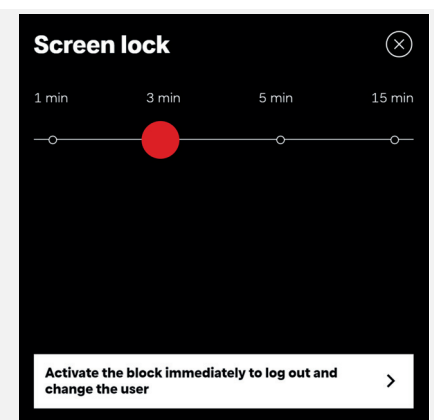



Glen Dimplex Thermal Solutions

Zentrale

Glen Dimplex Deutschland GmbH
Am Goldenen Feld 18
D-95326 Kulmbach

T +49 9221 709-100
F +49 9221 709-339
dimplex@gdts.one
www.gdts.one

Geschäftsstelle Österreich

Glen Dimplex Austria GmbH
Hauptstraße 71
A-5302 Henndorf am Wallersee

T +43 6214 20330
F +43 6214 203304
info@dimplex.at
www.dimplex.at

Office France

Dimplex SAS
7 rue d'Überach
67590 Schweighouse Sur Moder

T +33 3 88 07 18 00
F +33 3 88 07 18 01
dimplex-ST@dimplex.de
www.dimplex.de/fr