

BLITZDUCTORconnect BCO CL2 BD...

- DE Einbauanleitung
- GB Installation instructions
- IT Istruzioni di montaggio
- FR Instructions de montage
- NL Montagehandleiding
- ES Instrucciones de montaje
- PT Instruções de montagem
- DK Monteringsvejledning
- SE Monteringsanvisning
- FI Asennusohje
- GR Οδηγίες συναρμολόγησης
- PL Instrukcja montażu
- CZ Montážní návod
- TR Kurulum Talimatları
- RU Инструкция по монтажу
- CN 安装说明
- HU Szerelési útmutató
- JP 設置説明書

BCO CL2 BD...	HC10A 24
U _N	24 V DC
U _C	45 V DC
I _L	10 A @ + 80 °C
θ °C	-40°C ... +80°C
IP-Code	20

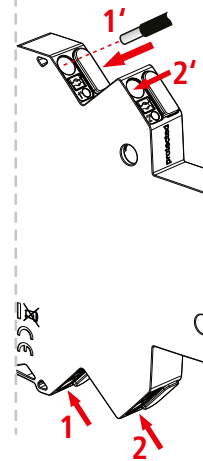
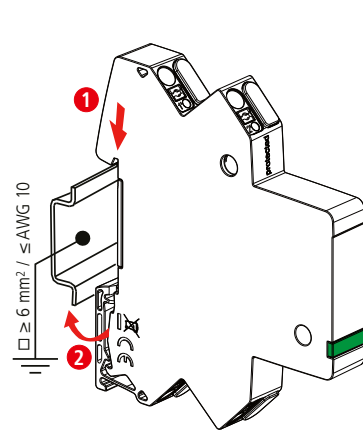

- 8 - 9 mm
□ 0.2 - 2.5 mm² (24 - 14 AWG)
 - 8 - 9 mm
□ 0.2 - 2.5 mm²
 - 8 - 9 mm
□ 0.25 - 2.5 mm² *)
 - 8 - 9 mm
□ 0.25 - 2.5 mm² **)
- *) with wire end ferrule and plastic collar / mit Aderendhülse und Kunststoffkragen
**) with wire end ferrule without plastic collar / mit Aderendhülse ohne Kunststoffkragen

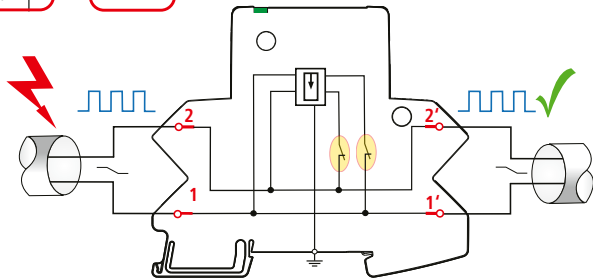
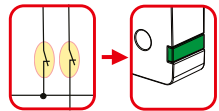
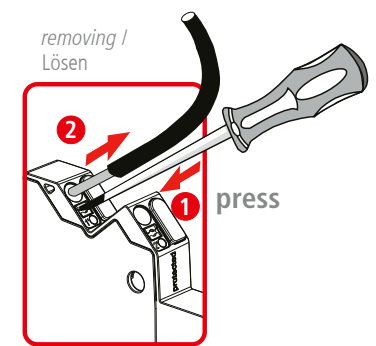
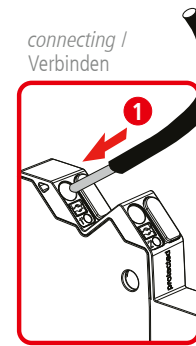

BCO CL2 BD HC10A 24

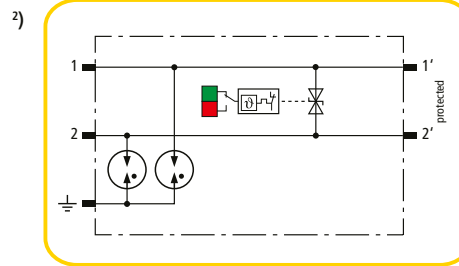

BCO CL2 BD HC10A 24

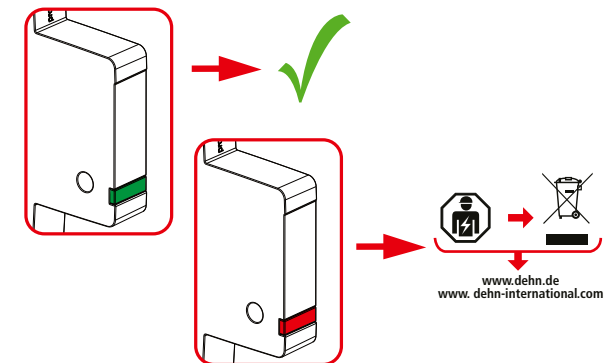
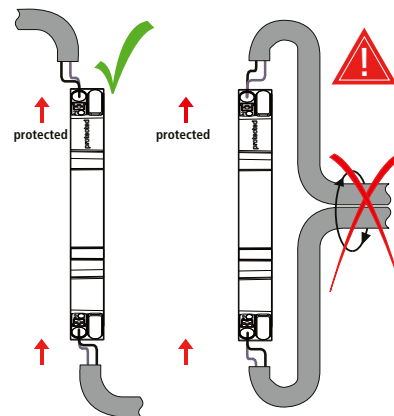
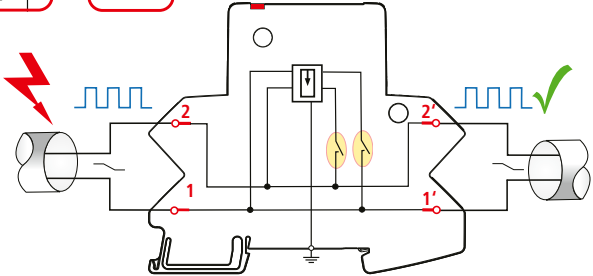
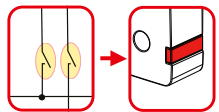
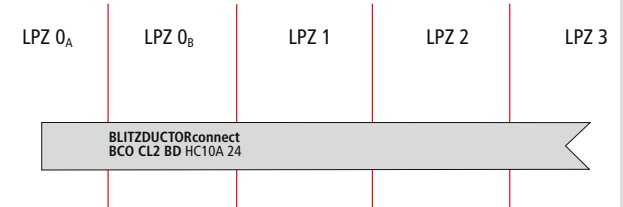

www.dehn.de
www.dehn-international.com

